

Project:	
Location:	
Model#: SM1224-SW-120-WH	Type:
Client:	Qty:
Prepared by:	Date:

SERIES SPECIFICATIONS

To supply Tam-lite SM12 series of LED fixtures as specified



PERFORMANCE SPECIFICATIONS

Luminance Distribution Chart

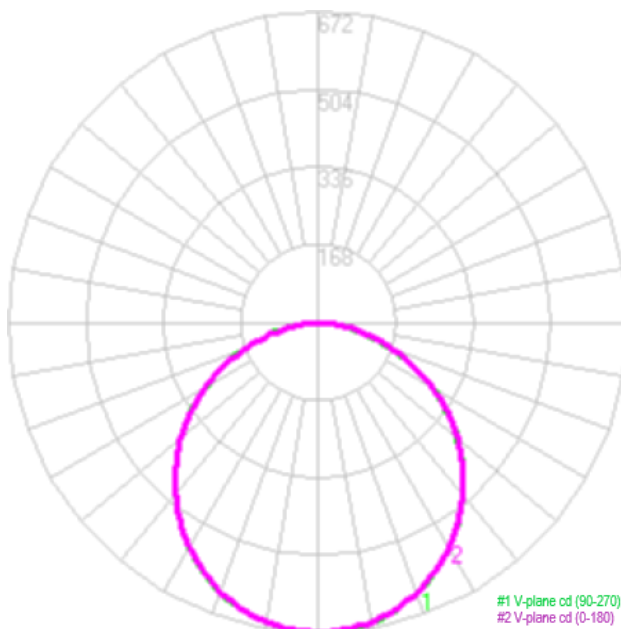

Isolux Diagram

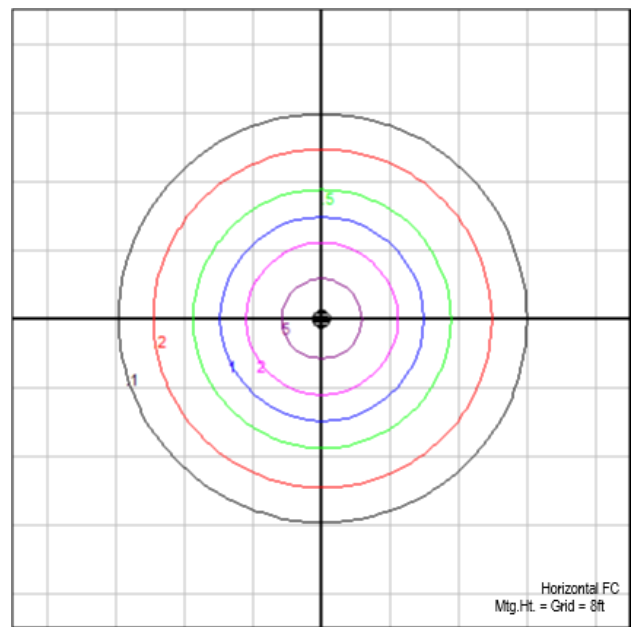

Zonal Lumen Summary

Zone	Lumens	Zone	Lumens	Zone	Lumens	Zone	Lumens	Zone	Lumens	Zone	Lumens
0-10	63.46	30-40	328.55	60-70	226.97	90-100	0	120-130	0	150-160	0
10-20	181.41	40-50	338.88	70-80	124.84	100-110	0	130-140	0	160-170	0
20-30	273.87	50-60	303.82	80-90	30.25	110-120	0	140-150	0	170-180	0

Total Initial Lumen Output; 1872.05 lm



Project:	
Location:	
Model#: SM1224-SW-120-WH	Type:
Client:	Qty:
Prepared by:	Date:

Co-efficient of Utilization

RC	80				70				50			30			10			0
RW	70	50	30	10	70	50	30	10	50	30	10	50	30	10	50	30	10	0
RF	20				20				20			20			20			20
0	119	119	119	119	116	116	116	116	111	111	111	106	106	106	102	102	102	100
1	109	104	100	96	106	102	98	95	98	94	92	94	91	89	90	88	86	84
2	99	91	84	78	96	89	83	77	85	80	76	82	78	74	79	75	72	70
3	90	80	72	65	88	78	71	65	75	69	63	72	67	62	70	65	61	59
4	83	71	62	55	80	69	61	55	67	60	54	64	58	53	62	57	53	50
5	76	63	54	47	74	62	54	47	60	52	47	58	51	46	56	50	46	44
6	70	57	48	41	68	56	47	41	54	47	41	52	46	41	51	45	40	38
7	65	52	43	37	63	51	42	36	49	42	36	48	41	36	46	40	36	34
8	61	47	38	33	59	46	38	33	45	38	32	44	37	32	43	36	32	30
9	57	43	35	29	55	43	35	29	41	34	29	40	34	29	39	33	29	27
10	53	40	32	27	52	39	32	27	38	31	26	37	31	26	36	30	26	24

Initial Lumen Output: 1872lm

CBCP: 672 CD

UL Classification: Damp Location Listed

Limited Product Warranty: 5 year(s)

Efficacy: 78lm/W

Luminaire Type: Direct - Surface Mount

Certification Standards: cETLus

Max Candela: 672cd

Environmental Rating(s): IP20

CCN Number: 4007670

LED SPECIFICATIONS

Source Type: LED

CRI: >80

Colour Temperature: 3000K, 4000K or 5000K Field Selectable

ELECTRICAL SPECIFICATIONS

Input Voltage: 120Vac

Current Draw at 120Vac: 0.2000A

Dimming: Triac, Reverse Phase

Driver Certifications: c-RU-us Class 2, FCC Part 15 Class B, RoHS

Input Frequency: 50/60 hz

Max On-Delay: < 1s

Over Temperature Protection: Auto Recovery, The fixture shall shut down and return to operation when the temperature returns to normal.

Fixture Draw: 24W

Power Factor at 120Vac: > 0.9

Short Circuit Protection: Auto Recovery. The output shall return to normal when the fault condition is removed.

PHYSICAL SPECIFICATIONS

Finish Colour: White

Housing Material: High Grade Plastic

Reflector Material: Acrylic

Finish Type: Injection molded colour

Lens Material: PMMA

Entries: One (1), Back Mount

Mounting:: Surface, back mount

Lens Type: Diffused



Project:	
Location:	
Model#: SM1224-SW-120-WH	Type:
Client:	Qty:
Prepared by:	Date:

SHIPPING INFORMATION

OrderingCode(s): SM1224-SW-IP20

Carton Quantity: 10

Box Quantity: 1

Carton Dimensions (L-W-H):

47.2cm(18.58")*34.1cm(13.43")*32.9cm(12.95")

Box Dimensions (L-W-H):

4.7cm(1.8")*34.1cm(13.43")*32.9cm(12.95")

LINE DRAWING

Line Drawings

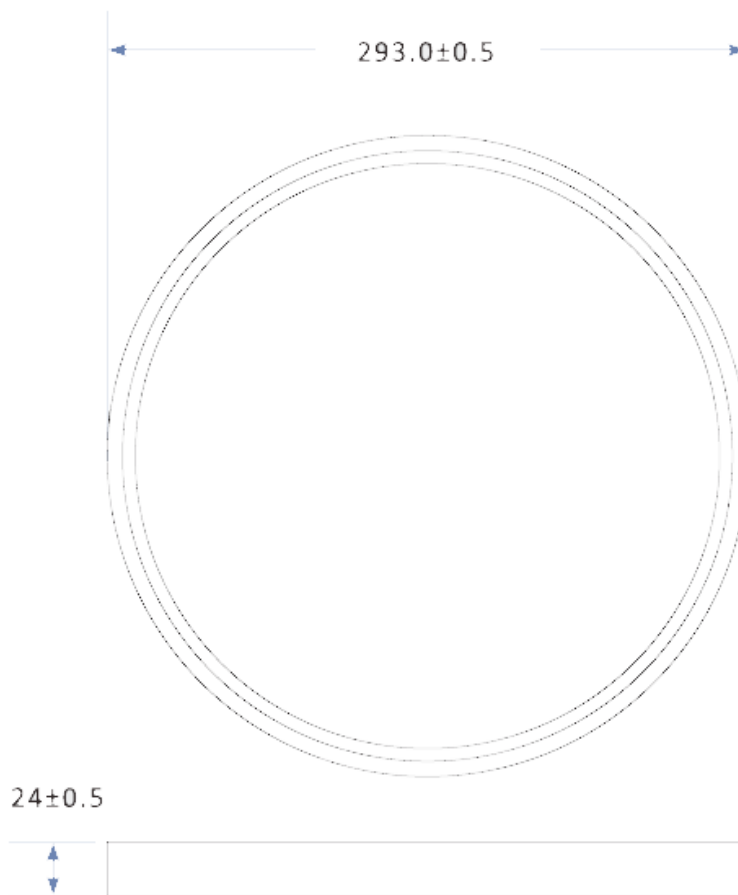



Project:	
Location:	
Model#: SM1224-SW-120-WH	Type:
Client:	Qty:
Prepared by:	Date:

SERIES ARCHITECTURE

Series Architecture

SM	-	12	-	24	-	sw	-	120	-	WH	-	
Part	Size		Wattage		Colour		Voltage		Finish		Mounting Options	
SM	12	12 inch	24	24W	SW	Selectable White	120	120Vac	WH	White	blank	Flush Mount
						3000K, 4000K, 5000K					SFM	Semi Flush Mount

2022-12-02